



2024 CATALOG



DOWNLIGHTS
Slim Colour Changeable
Dimmable LED Downlight



SECURITY LIGHT
Remote Control High Lumen
Output Security Light



CABINET LIGHTS
Color Changeable LED
Reading Light



SMART DOWNLIGHTS
Smart LED Downlight With
Interchangeable Beams



SOLAR LIGHT
LED Solar Spike Light



SMART SECURITY
High Lumen Output Outdoor
Smart Security Light



Factory Add: No.255 Yindong South Rd., Yinzhou Economic Development Zone,
Zhanqi Town, Ningbo City, Zhejiang, China.

Email: sales@silanglighting.com

Website: www.silanglighting.com

Tel: (+86)-574-55003160

North America

SILANGLIGHTING

COMPANY PROFILE



20000^{m²}
Plant area

200+
Workers

30 +
Export country

\$30 million
Annual output



As a rising star of LED lighting industry, Ningbo SILANG Lighting is specialized in designing, manufacturing and developing LED lights. With years of lighting experience, we are dedicated to helping with the upgrading of indoor/outdoor lighting environment through our high-quality led downlights, security floodlights, smart lights and solar lights.

The company is located in Ningbo city, which is only a 30-minute drive from Ningbo Port. SILANG possesses strong advantages of both fast delivery and strong supply chain system.

SILANG's easy-to-use, innovative and reliable products are highly preferred by our loyal clients in Europe, Australia, New Zealand and now US markets. We offer a wide range of products and services, as well as multiple solutions to support the market growth you want.

SILANG embraces technical innovation and revolution. We believes that research and development investment is the key to brings new and innovative products to market with customer involvement.

Whatever your professional lighting needs, we'd love to help you with your current/next project.





FACILITY

CERTIFICATION



OUR STRENGTH



Professional Lights with Competitive Price: Well-designed products are developed and manufactured by our own lab and factory, together with our optimal self-made drivers. Our state-of-the-art equipment allows us to always provide quality LED lighting solutions with a reasonable price and flexible ordering quantities.



Rigorous Quality Control: Focus on LED lighting for 10 years, the whole manufacturing process strictly follows the ISO9001 Quality Management System, meeting RCM, CE and ETL criteria. The QC department conducts IQC, inspection during the assembling, random inspection and even full inspection on request before shipping.



Stable Delivery Time: Having 200+ skilled workers and 22 assembly lines, we've reached a product capacity of 600,000pcs per month, ensuring a fast delivery time. Meanwhile, locating in the port city, Ningbo, also means a great convenience for exportation.



Strong R&D Capability: SILANG embraces technical innovation and revolution. Thanks to our experienced and talented team members, SILANG's independent R&D department maintains a consistent pace of releasing 6+ new products each year. Besides, we offer deep customization service by requests from Australian, European and American markets.

Downlight



Security Light



Batten Light



Coming Soon...



DOWNLIGHT

Code DL-SG260-212D3
Wattage 12W
CCT(K) 2700K/3000K/4000K/5000K/6500K
Lumens 1050lm
Beam Angle 100°
Dimmable Yes(Triac)
Material Nylon+Al+PC
Height 30mm



29mm Super Thin Design

Suitable for various cans

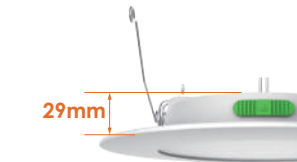

Adjustable Spring

Fit in 5"/6" can housing

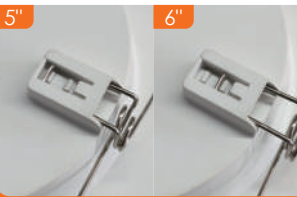

Easy to Install

Hook, push, and done



SG series White Black
5"/6" 5CCT LED Can Light

| SHII Series | | | | |
|-------------|----------------|----------------|----------------|----------------|
| Code | DL-SG260-212D3 | DL-SG360-212D3 | DL-SG260-212D5 | DL-SG360-212D5 |
| Wattage | 12W | 12W | 12W | 12W |
| Lumens | 1050lm | 960lm | 1050lm | 960lm |
| Beam Angle | 100° | 100° | 100° | 100° |
| Cutout | 5-6inch | 5-6inch | 5-6inch | 5-6inch |
| Height | 30mm | 28.5mm | 30mm | 28.5mm |





SECURITY LIGHT



CEILING LIGHT

Code WL-YDR-224P-D4
Wattage 24W
CCT(K) 3000K/4000K/6500K
Lumens 1900lm
Beam Angle 90°/head
Working Mode Auto/D2D/On time
Detection Brightness 5-2000Lux
Detection Angle 120°
Detection Distance 10m max
Material PC



Photocell/Motion Sensor
Wide applications in various space

Multiple Working Modes
AUTO/D2D/ON TIME modes available

Optional Control Methods
Remote/App control available



YDR series White Black

3CCT Outdoor Photosensitive LED Security Light

| SHII Series | | | | |
|-----------------|-----------------------|----------------|------------------|--------------|
| Code | SL-YDR03-224D8 | WL-YDR-224P-D5 | WL-YDR-224P-D4 | WL-YD2R-224P |
| Wattage | 24W | 24W | 24W | 24W |
| Lumens | 1900lm(BK)/2500lm(WH) | | | |
| Working Mode | D2D/On time | Auto/On time | Auto/D2D/On time | Auto/On time |
| Detection Angle | / | 120° | 120° | 120° |



Code WL-YDS-240P-D4
Wattage 40W
CCT(K) 3000K/4000K/6500K
Lumens 3800lm
Beam Angle 90°/head
Working Mode Auto/D2D/On time
Detection Brightness 5-2000Lux
Detection Angle 120°
Detection Distance 10m max
Material PC+Glass



Photocell/Motion Sensor
Wide applications in various space

Multiple Working Modes
AUTO/D2D/ON TIME modes available

Optional Control Methods
Remote/App control available



YDS series White Black

3CCT Outdoor Photosensitive LED Security Light

| SHII Series | | | | |
|-----------------|-----------------------|----------------|------------------|--------------|
| Code | WL-YDS03-240D8 | WL-YDS-240P-D5 | WL-YDS-240P-D4 | WL-YDS-240P |
| Wattage | 40W | 40W | 40W | 40W |
| Lumens | 3800lm(BK)/4400lm(WH) | | | |
| Working Mode | D2D/On time | Auto/On time | Auto/D2D/On time | Auto/On time |
| Detection Angle | / | 120° | 120° | 120° |





SECURITY LIGHT

Code WL-YER-230P-D4
Wattage 30W
CCT(K) 3000K/4000K/6500K
Lumens 2400lm
Beam Angle 90°/head
Working Mode Auto/D2D/On time
Detection Brightness 5-2000Lux
Detection Angle 120°
Detection Distance 10m max
Material Aluminum+PC



Heat Dissipation Design

Longer service life & more durable



Photocell/Motion Sensor

Wide applications in various space



Multiple Working Modes

AUTO/D2D/ON TIME modes available



YER series White Black

3CCT Round Photosensitive LED Security Light

| SHII Series | | | | |
|-----------------|----------------|----------------|------------------|--------------|
| Code | WL-YER03-230D8 | WL-YER-230P-D5 | WL-YER-230P-D4 | WL-YER-230P |
| Wattage | 30W | 30W | 30W | 30W |
| Lumens | 2400lm | 2400lm | 2400lm | 2400lm |
| Working Mode | D2D/On time | Auto/On time | Auto/D2D/On time | Auto/On time |
| Detection Angle | / | 120° | 120° | 120° |



SECURITY LIGHT

Code WL-YES-260P-D4
Wattage 60W
CCT(K) 3000K/4000K/6500K
Lumens 4800lm
Beam Angle 90°/head
Working Mode Auto/D2D/On time
Detection Brightness 5-2000Lux
Detection Angle 120°
Detection Distance 10m max
Material Al+PC+Glass



Heat Dissipation Design

Longer service life & more durable



Photocell/Motion Sensor

Wide applications in various space



Multiple Working Modes

AUTO/D2D/ON TIME modes available



YES series White Black

US 3CCT Square Photosensitive LED Security Light

| SHII Series | | | | |
|--------------------|----------------|----------------|------------------|--------------|
| Code | WL-YES03-260D8 | WL-YES-260P-D5 | WL-YES-260P-D4 | WL-YES-260P |
| Wattage | 60W | 60W | 60W | 60W |
| Lumens | 4800lm | 4800lm | 4800lm | 4800lm |
| Working Mode | D2D/On time | Auto/On time | Auto/D2D/On time | Auto/On time |
| Detection Duration | / | 3secs-8mins | 3secs-8mins | 3secs-8mins |





BATTEN LIGHT

Coming Soon...

| | |
|------------|-------------------------------|
| Code | SL-LT-JAL812 |
| Wattage | 16W/18W/20W |
| CCT(K) | 2700K/3000K/4000K/5000K/6500K |
| Lumens | 1440lm/1660lm/1760lm |
| Beam Angle | 110° |
| Dimmable | Yes |
| Lenth | 1.2m |
| Material | PC+ABS |



3 Wattage Turnable
Switch the brightness you need

Interconnectable
Connect the lights for suitable lenth

Common Shrapnel Buckle
Easy to install or uninstall



New **T8 series** White

3CCT LED Batten Light



FLC36 Portable Floodlight

- ★ 3CCT+3WT
- ★ Super bright & hangable
- ★ Beam angle adjustable

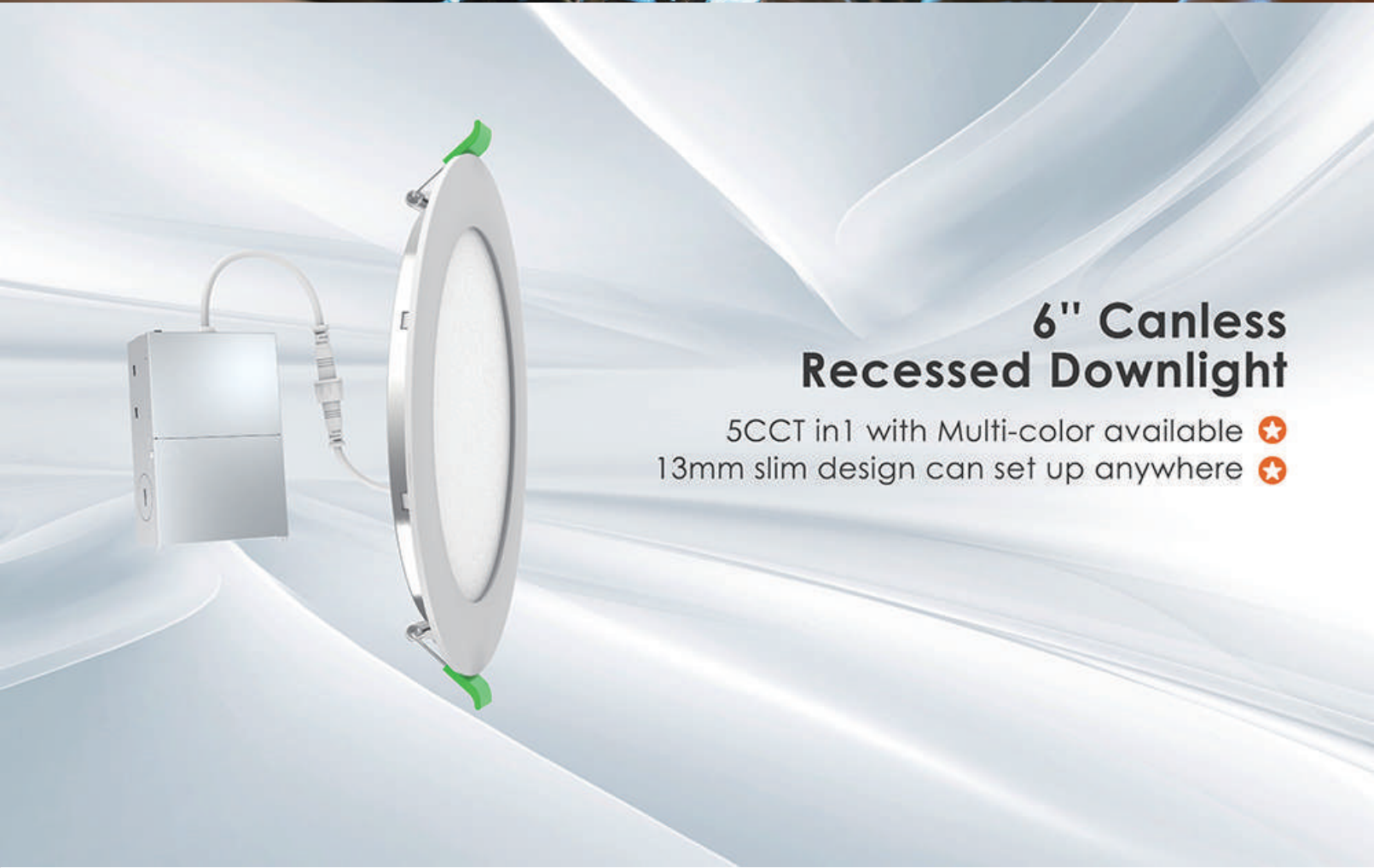

6" Canless Recessed Downlight

- 5CCT in1 with Multi-color available ★
- 13mm slim design can set up anywhere ★



Battery Light



UB01

UB05

UB06R



UB02

UB03

UB04

Solar Light



OT-01A

OT-01B



OT-04

OT-05

Coming Soon...



UB02 Beginner Serie

SV25S

Outdoor Light NEO Series

GLOBAL

| | |
|----------------|-----------------------------|
| Code | UB01 |
| Wattage | 3W |
| CCT(K) | 3000K/4000K/5000K/6000K+RGB |
| Lumens | 200lm |
| Beam Angle | 24° |
| Dimmable | Yes(Triac) |
| Material | ABS |
| Battery | 3.7V 4000mAh |
| USB Charging | Type-C |
| Endurance Time | 4.5h |



Anti-Glare Design

Eye protection

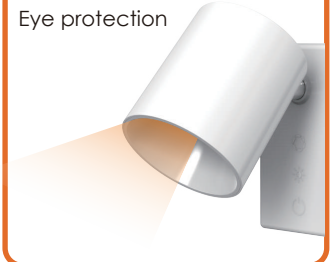

Stretch Sheet Available

Make beam angle bigger

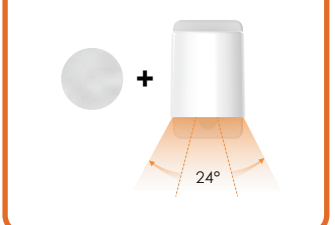

Adjustable Head

Flexible lighting angle

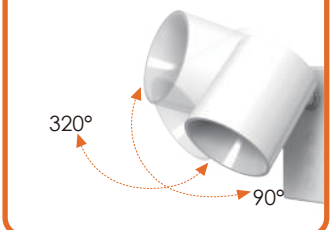

New UB01 series

White

Color Changeable LED Reading Light





CABINET LIGHT



CABINET LIGHT

Code UB05
Wattage 4W
CCT(K) 3000K/4000K/6000K
Lumens 320lm
Beam Angle 0°-70°
Dimmable Yes
Material ABS
Battery 3.7V 4000mAh
USB Charging Type-C
Endurance Time 4h
Detection Angle 120°

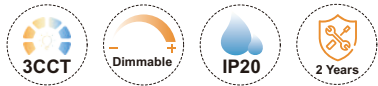

2 Working Modes

AUTO/HAND WAVE modes available



Beam Angle Adjustable

Customize the light beam you want

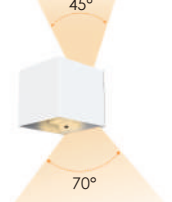

Installation Back Sheet

No pre-Installation required and easy to remove



New UB05 series



3CCT Square Wall Light



Code UB02-30
Wattage 1.5W
CCT(K) 3000K-6000K
Lumens 120lm
Beam Angle 120°
Dimmable Yes
Material ABS+PC
Lenth 30cm
Battery 3.7V 1500mAh
USB Charging Type-C
Endurance Time 6h
Detection Angle 120°

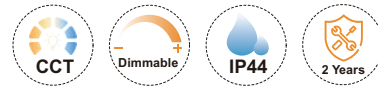

Motion/Wave Sensor

Wide applications in various space



Magnetic Adsorption

Easy to install and get recharged



4 Working Modes

DAY/NIGHT/HAND WAVE/ ON TIME modes available



UB02 series



Wireless Side-Emitting Under Cabinet Bar Light

| UB02 series | New | Coming | Coming |
|---------------|--------------|--------------|--------------|
| | | | |
| Code | UB02-30 | UB02-40 | UB02-60 |
| Wattage | 1.5W | 2W | 3W |
| Lumens | 120lm | 160lm | 240lm |
| Battery | 3.7V 1500mAh | 3.7V 2000mAh | 3.7V 3000mAh |
| Duration Time | 6h | 6h | 6h |
| Lenth(L) | 30mm | 40mm | 60mm |





CABINET LIGHT



CABINET LIGHT

Code UB06R
Wattage 2W
CCT(K) 3000K/4000K/6000K+RGB
Lumens 160-180lm
Beam Angle 45°/110°
Dimmable Yes
Material ABS
Diameter 85mm
Battery 3.7V 2000mAh
USB Charging Type-C
Endurance Time 6H



Wireless Connectable
Convenient group control via remote control

2 Beam Angles Available
Choose the one more suitable

2 Modes Optional
Motion/ Handwave sensor activated

New **UB06 series** White

Wireless Connectable LED Cabinet Light

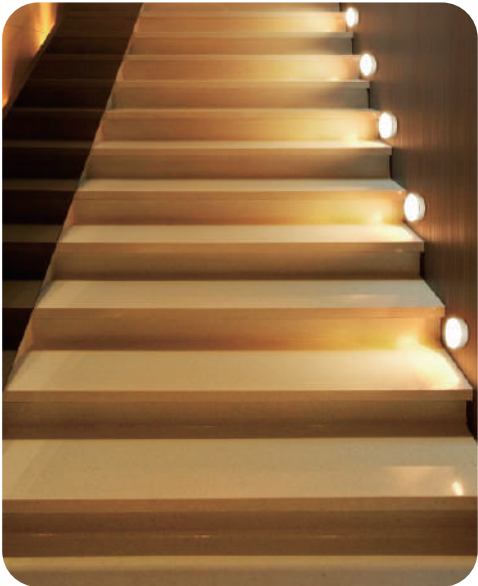

UB | Wireless Surface-Emitting Under Cabinet Bar Light

SPECIFICATIONS

| | | | |
|-------------------------------|------------------|--------------|--------------|
| Code | UB03-30 | UB03-40 | UB03-60 |
| Wattage | 1.5W | 2W | 3W |
| CCT(K) | 3000-6500K | | |
| Lumens | 120lm | 160lm | 240lm |
| Dimmable | Yes | | |
| Battery | 3.7V 1500mAh | 3.7V 2000mAh | 3.7V 3000mAh |
| USB Charging | Type-C | | |
| Charging Time | 3 hours | 4 hours | 5 hours |
| Endurance Time | 6 hours | | |
| Working Mode | AUTO/OFF/ON TIME | | |
| Detection Angle | 120° | | |
| Sensor Duration Time | 30s | | |
| Human Body Detection Distance | 0-4m | | |
| Hand Scan Detection Distance | <10cm | | |
| Lenth(L) | 30cm | 40cm | 60cm |
| Material | ABS+PC | | |

White

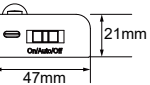
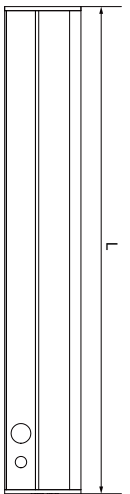

UB | Side-Emitting Connectable Under Cabinet Bar Light

SPECIFICATIONS

| | | | |
|-------------------------------|------------------------------|---------|---------|
| Code | UB04-30 | UB04-40 | UB04-60 |
| Wattage | 5W | 6.5W | 10W |
| CCT(K) | 3000K-6500K | | |
| Lumens | 400lm | 520lm | 800lm |
| Dimmable | Yes | | |
| Input | 220-240V~50/60Hz | | |
| Output | 24V DC | | |
| Working Mode | AUTO/NIGHT/HAND WAVE/ON TIME | | |
| Detection Angle | 120° | | |
| Sensor Duration Time | 30s/60s/120s | | |
| Human Body Detection Distance | 0-4m | | |
| Hand Scan Detection Distance | <10cm | | |
| Lenth(L) | 30cm | 40cm | 60cm |
| Material | ABS+PC | | |

White

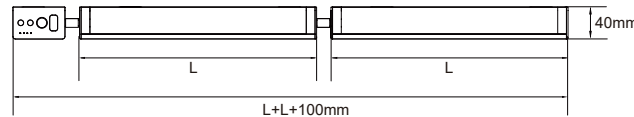



SOLAR LIGHT



SOLAR LIGHT

Code OT-01A-4P3
Wattage 4W
CCT(K) 3000K/4000/6500K
Lumens 180lm
Beam Angle 30°
Dimmable Yes
Material ABS+PC
Height 9mm
Solar Panel 5.5VDC
Battery 3.7V1800mAh
USB Charging Type-C
Endurance Time 2.5h
Detection Angle 120°

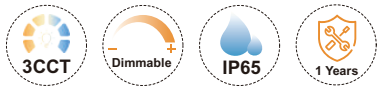

Adjustable Solar Panel
Efficient solar powered & save energy



Sensitive Motion Sensor
Sensitive Motion Sensor



Adjustable Head
Illuminate specific items you need



OT-01 series



30°/90° LED Solar Spike Light

| OT series |  |  |  |  |  |  |
|-----------------|---|---|---|--|---|---|
| Code | OT-01A-1D3 | OT-01A-1R | OT-01A-4P3 | OT-01B-1D3 | OT-01B-1R | OT-01B-4P3 |
| Wattage | 1.2W | 1.2W | 4W | 1.2W | 1.2W | 4W |
| Lumens | 60-80lm | 60-80lm | 180lm | 60-80lm | 60-80lm | 180lm |
| Illumination | 240Lux/1m | 240Lux/1m | 750Lux/1m | 240Lux/1m | 240Lux/1m | 750Lux/1m |
| Beam Angle | 30° | 30° | 30° | 120° | 120° | 120° |
| Detection Angle | / | / | 120° | / | / | 120° |
| Endurance Time | 8-10h | 8-10h | 2.5h | 8-10h | 8-10h | 2.5h |



OT | Colour Adjustable LED Solar Security Light

SPECIFICATIONS

| | |
|----------------------|----------------------------|
| Code | OT-04 |
| Wattage | 5W |
| CCT(K) | 3000K-6500K |
| Lumens | 520lm |
| Dimmable | Yes |
| Beam Angle | 100° |
| Solar Panel | 5.5VDC |
| Battery | 3.7V 1800mAh |
| Charging Time | 8-10 hours by solar energy |
| USB Charging | 3.5 hours by Type-C |
| Endurance Time | 60 mins |
| Worknig Mode | AUTO/D2D/ON TIME |
| Detection Angle | 120° |
| Sensor Duration Time | 30s/60s/120s |
| Detection Distance | 6m max |
| Material | ABS+PC |

Black

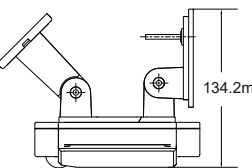
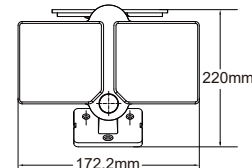

OT | Colour Adjustable LED Solar Security Light

SPECIFICATIONS

| | |
|----------------------|----------------------------|
| Code | OT-05 |
| Wattage | 5W |
| CCT(K) | 3000K/4000K/6500K |
| Lumens | 400lm |
| Dimmable | No |
| Beam Angle | 100° |
| Solar Panel | 5.5VDC |
| Battery | 3.7V 1800mAh |
| Charging Time | 8-10 hours by solar energy |
| USB Charging | 3.5 hours by Type-C |
| Endurance Time | 80 mins |
| Detection Brightness | 5-2000Lux |
| Detection Angle | 120° |
| Sensor Duration Time | 3secs-8mins |
| Detection Distance | 10m max |
| Material | ABS+PC |

Black

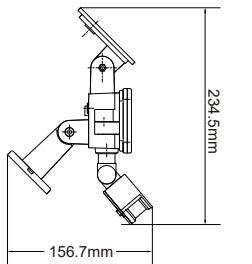
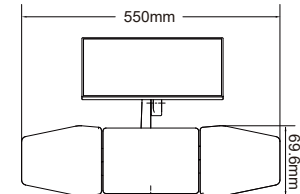

Coming Soon...

Hand wave version

Motion sensor version

UB02 Beginner Series

Easy operation & Cost effective

SV25S Corner Lamp

Customize the way you like with high space utilization

Outdoor Light NEO Series

with Brand New CommandX System



Make group control
more convenient

The coming interconnectable product family