

Colour Switchable LED Downlight With Isolated Dimmable Driver

FINISH COLOUR



COLOUR TEMPERATURE



SPECIFICATIONS

| Code | DL-YB25-109D3 | DL-YF30-112D3 | DL-YB40-115D3 |
|-----------------|-------------------|---------------|---------------|
| Wattage | 9W | 12W | 15W |
| CCT(K) | 3000K/4000K/5700K | | |
| Lumens | 800lm | 1100lm | 1350lm |
| Efficiency | 80lm/W | | |
| CRI | > 80 | | |
| Beam Angle | 110° | | |
| Input | 220-240V~50/60Hz | | |
| Dimmable | Yes | | |
| Operating Temp. | -20°C ~+45°C | | |
| Dimension(DxH) | 85x40mm | 113x40mm | 150x45mm |
| Material | Aluminum+PC | | |

DIMENSIONS

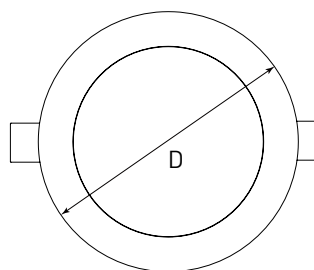

9W Cutout: 70-75mm
12W Cutout: 90-100mm
15W Cutout: 120-130mm

